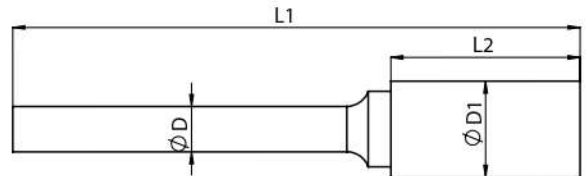
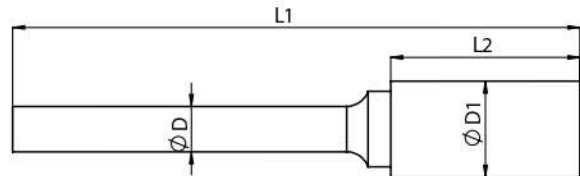

SA
Cylindrical without end cut

Unit : mm

3mm Shank			Tool No	Standard cut	Supreme cut	Deluxe cut	CTI Number
Head Diameter	Head length	Overall Length		EDP No.	EDP No.	EDP No.	
ØD1	L2	L1					
1.5	6	50	MC4L	FAC0200588	FAC0200589	FAC0200590	SA-41ML2
1.5	6	75	MC4L1	FAC0200591	FAC0200592	FAC0200593	SA-41ML3
1.5	6	38	MC4	FAC0200585	FAC0200586	FAC0200587	SA-41M
2.5	11	38	MC5	FAC0200594	FAC0200595	FAC0200596	SA-42M
2.5	11	50	MC5L	FAC0200597	FAC0200598	FAC0200599	SA-42ML2
2.5	11	75	MC5L1	FAC0200600	FAC0200601	FAC0200602	SA-42ML3
3	16	38	MC1	FAC0200563	FAC0200565	FAC0200566	SA-43M
3	16	75	MC1L1	FAC0200570	FAC0200571	FAC0200572	SA-43ML3
3	16	50	MC1L	FAC0200567	FAC0200568	FAC0200569	SA-43ML2
6.3	6.3	38	MC2	FAC0200573	FAC0200574	FAC0200575	
6.3	12.7	38	MC3	FAC0200582	FAC0200583	FAC0200584	SA-51M
6.3	6.3	50	MC2L	FAC0200576	FAC0200577	FAC0200578	
6.3	6.3	75	MC2L1	FAC0200579	FAC0200580	FAC0200581	

SA
Cylindrical without end cut

CARBIDE BURRS

Unit : mm

6mm Shank			Tool No	Standard cut	Supreme cut	Deluxe cut	CTI Number
Head Diameter	Head length	Overall Length		EDP No.	EDP No.	EDP No.	
ØD1	L2	L1					
3	12.7	50	C0	FAC0200208	FAC0200209	FAC0200210	SA-11M
3.8	14	50	C1	FAC0200211	FAC0200212	FAC0200213	SA-13M
5	16	50	C11	FAC0200306	FAC0200307	FAC0200308	SA-14M
6	20	50	C2	FAC0200220	FAC0200221	FAC0200222	
6	20	170	C2L2	FAC0200232	FAC0200233	FAC0200234	SA-1ML6
6	25	50	C2H	FAC0200223	FAC0200224	FAC0200225	
6.3	16	66	C12	FAC0200309	FAC0200310	FAC0200311	SA-1
8	19	69	C3	FAC0200236	FAC0200237	FAC0200238	SA-2M
9.5	19	69	C4	FAC0200246	FAC0200247	FAC0200248	SA-3M
9.5	19	169	C4L2	FAC0200252	FAC0200253	FAC0200254	SA-3ML6
10	25	75	C13	FAC0200312	FAC0200313	FAC0200314	SA-3MZ
11	25	75	C14	FAC0200315	FAC0200316	FAC0200317	SA-4M
12.7	19	69	C5	FAC0200259	FAC0200263	FAC0200265	
12.7	14	64	C7	FAC0200281	FAC0200282	FAC0200283	
12.7	25	75	C8	FAC0200285	FAC0200286	FAC0200287	SA-5M
12.7	25	175	C8L2	FAC0200288	FAC0200289	FAC0200290	SA-5ML6
16	25	75	C6	FAC0200273	FAC0200275	FAC0200277	SA-6M
19	25	70	C9	FAC0200294	FAC0200296	FAC0200298	SA-7M
25	25	75	C10	FAC0200300	FAC0200302	FAC0200304	SA-9M